

Einzelheit Z M 1:5

Einzelheit X M 1:5

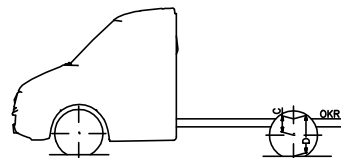
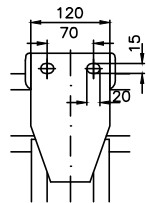
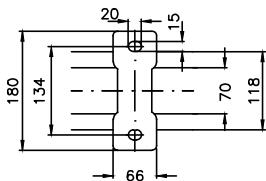

Material thickness: Body support 0.1.0 mm
Longitudinal member 0.1.0 mm

IF3 Chassis with cab
IF2 Sprinter standard
IF1 Mercedes 4325 mm, overhang 1815 mm
MO3 Engine OM 681 DE 22 LA 120 kW (163 hp) 3800 rpm
MO2 Engine In-competition EPA 14/GWB
IF7 Tyre LT 215/85 R16
SO4 Adjustable co-drivers seat
1040 Frontal

Important notes:
- It is the responsibility of the bodybuilder to ensure that the vehicle is suitable for homologation after the body has been mounted.
- The drawing is simplified to some extent and is not legally binding. For more details and further explanations please see the M&AC-Truck User Guide in the bodybuilder portal.
- Please check whether the drawing specification complies with the chassis configuration of your order.
- Optional equipment codes not listed here, KW-codes and changes resulting from feasibility checks (BBA) are not included in the drawing.

vehicle type:	A		B		C		D		G		α°	β°	δ°	Measurements of laden vehicle.		
	laden*	unladen	laden*	unladen	laden*	unladen	laden*	unladen	laden*	unladen				RA (t)	RA (t)	
906.155-13	-	-	-	-	25.5	25.5	26.9	= 95.1	18	13	14					
tyres	215/85R16		215/85R16		gross vehicle weight		GW (t)	FA (t)	RA (t)		Subject to change.					
							2269	839								
*laden = Stalke work to capacity													23.04.15		3500/4x2/170.3	
													Mercedes-Benz		HVA 9061000127	

All dimensions refer to the standard version.
Our instructions for the manufacture of superstructures must be observed, when planning in fit bodies of other than Mercedes-Benz manufacturers.
Dimensions are subject to a tolerance of up to +/- 3%
Adapt. (Dept.) TE/800
70546 Stuttgart